

# Environmental Toxicology Laboratory

(J.P. Giesy Group)



**TOXICOLOGY CENTRE**  
**44 CAMPUS DRIVE**  
**SASKATOON, SK S7N 5B3**  
**CANADA**

# Environmental Toxicology Laboratory (J.P. Giesy Group)

University of  
Saskatchewan

**AQUATICS LABORATORY**  
*7,100 Square Feet*

Toxicology Ctr.  
Ground Floor

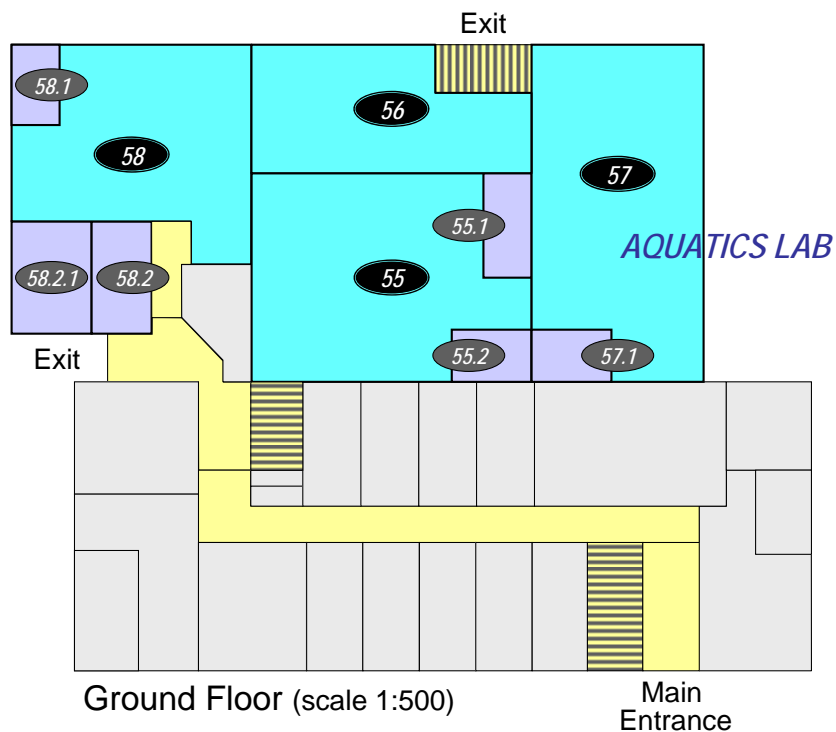

## Composed of:

*55) Aquatics Culture Room*    *55.1) Control & Maintenance*  
*55.2) Environment Chamber*

*56) Water & Waste Water  
Treatment Facility*

*57) Aquatics Exposure Room*    *57.1) Environment Chamber*

*58) General Storage Room*    *58.1) Solvent Storage*  
*58.2) Electrical & Emergency Generator*

# **AQUATICS LAB**

## **Room 55. Aquatics Culture**



### **Dimensions**

1,800 Square Feet (30 X 60)

## **AQUATICS LAB**

### **Room 56. Water & Waste Water Treatment Facility**



### **Dimensions**

1,130 Square Feet (51 X 22)

## **AQUATICS LAB**

### **Room 57. Aquatics Exposure**



### **Dimensions**

1,800 Square Feet (30 X 60)

## **AQUATICS LAB**

### **Room 58. General Storage**



### **Dimensions**

2,240 Square Feet (43 X 52)

# Environmental Toxicology Laboratory (J.P. Giesy Group)

University of  
Saskatchewan

**CHEMISTRY LAB / OFFICE**  
**2,500 / 3,560 Square Feet**

Toxicology Ctr.  
First Floor

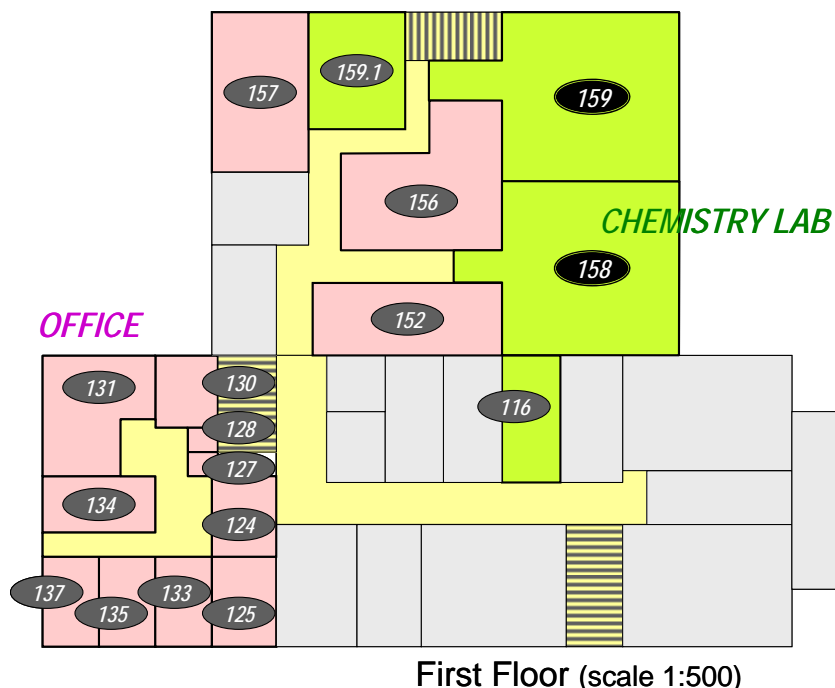

## Composed of:

*116) Walk in Freezer*

*158) Wet Chemistry Room*

*159) Instrument Room    159.1) High-Resolution GC/MS*

*124-137) Main Office    131) Dr. J.P. Giesy*

*152) Lounge*

*156-157) Graduate Student Office*

# **CHEMISTRY LAB**

## **Room 158. Wet Chemistry**



### **Dimensions**

1,140 Square Feet (33 X 35)

# **CHEMISTRY LAB**

## **Room 159. Instrument**



### **Dimensions**

1,030 Square Feet (33 X 31)

# **CHEMISTRY LAB**

## **Room 159.1. High Resolution GC/MS**

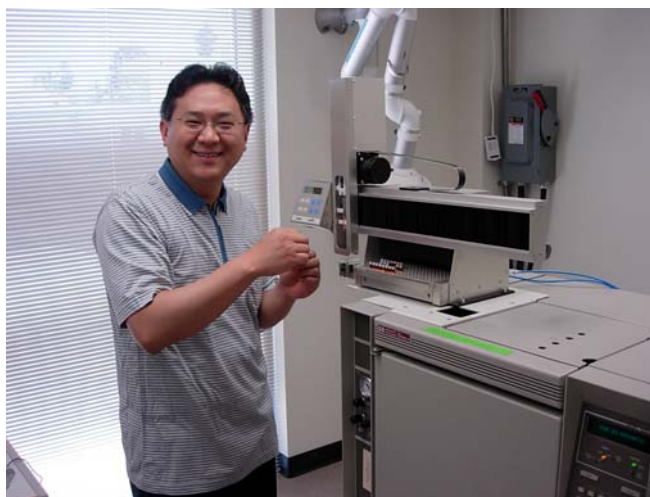
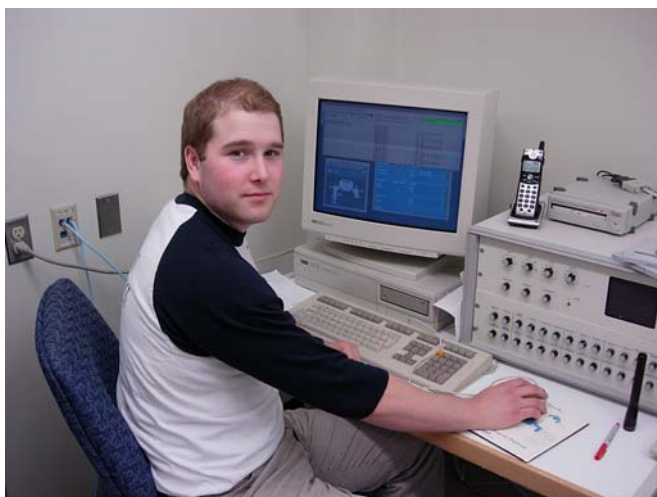

### **Dimensions**

320 Square Feet (16 X 20)

# Environmental Toxicology Laboratory (J.P. Giesy Group)

University of  
Saskatchewan

**BIOCHEMISTRY LAB**  
*2,260 Square Feet*

Toxicology Ctr.  
Second Floor

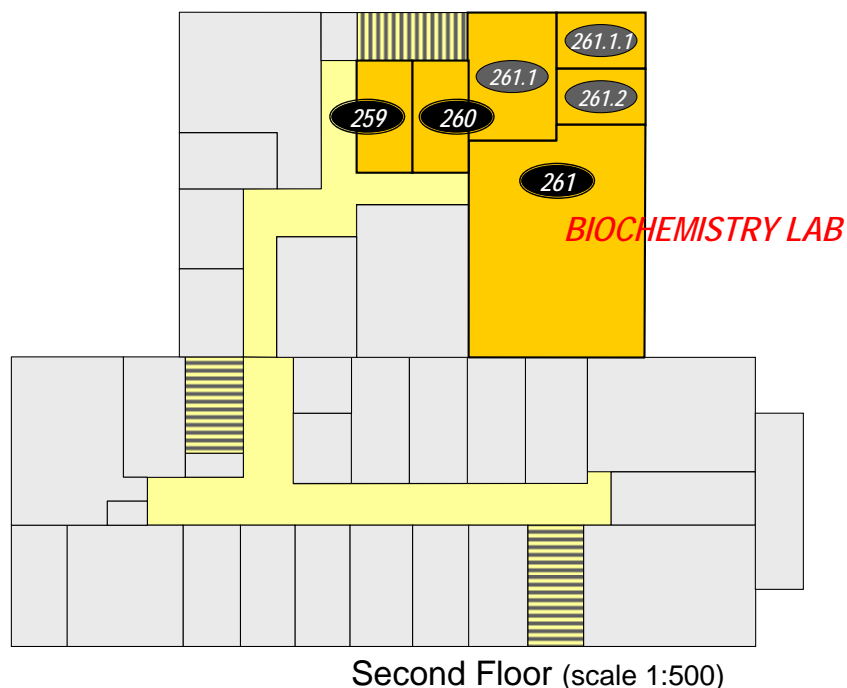

## Composed of:

*259) Autoclave & Glassware  
Preparation Room*

*260) Chemical Storage Room*

*261) Biochemistry & Molecular Biology Room*  
*261.1) Cell Culture*  
*261.1.1) Microscope*  
*261.2) Micro-balance*

## ***BIOCHEMISTRY LAB***

### **Room 259. Autoclave & Glassware Preparation**



#### **Dimensions**

230 Square Feet (12 X 20)

## ***BIOCHEMISTRY LAB***

### **Room 260. Chemical Storage**



#### **Dimensions**

180 Square Feet (9 X 20)

## **BIOCHEMISTRY LAB**

### **Room 261. Biochemistry & Molecular Toxicology**



### **Dimensions**

1,200 Square Feet (31 X 39)

# ***BIOCHEMISTRY LAB***

## **Room 261.1. Cell Culture**



### **Dimensions**

350 Square Feet (16 X 22)

## **BIOCHEMISTRY LAB**

### **Room 261.1.1. Microscope**

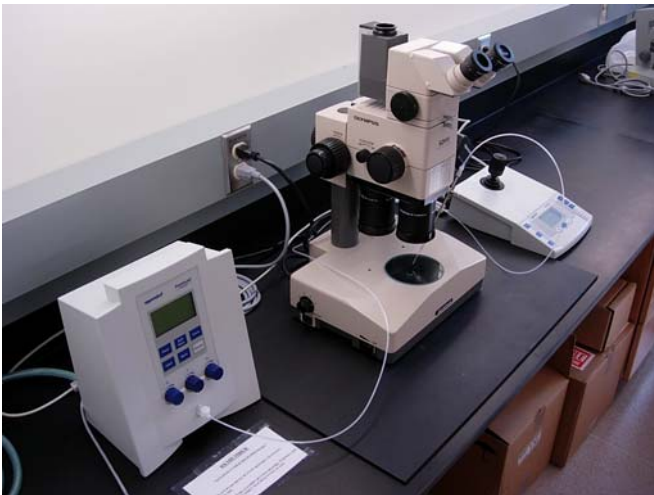

### **Dimensions**

140 Square Feet (15 X 9)

## **BIOCHEMISTRY LAB**

### **Room 261.2. Micro-Balance**



### **Dimensions**

150 Square Feet (15 X 10)